



Digital life made easy

Join-In for Grid 3

Spotify



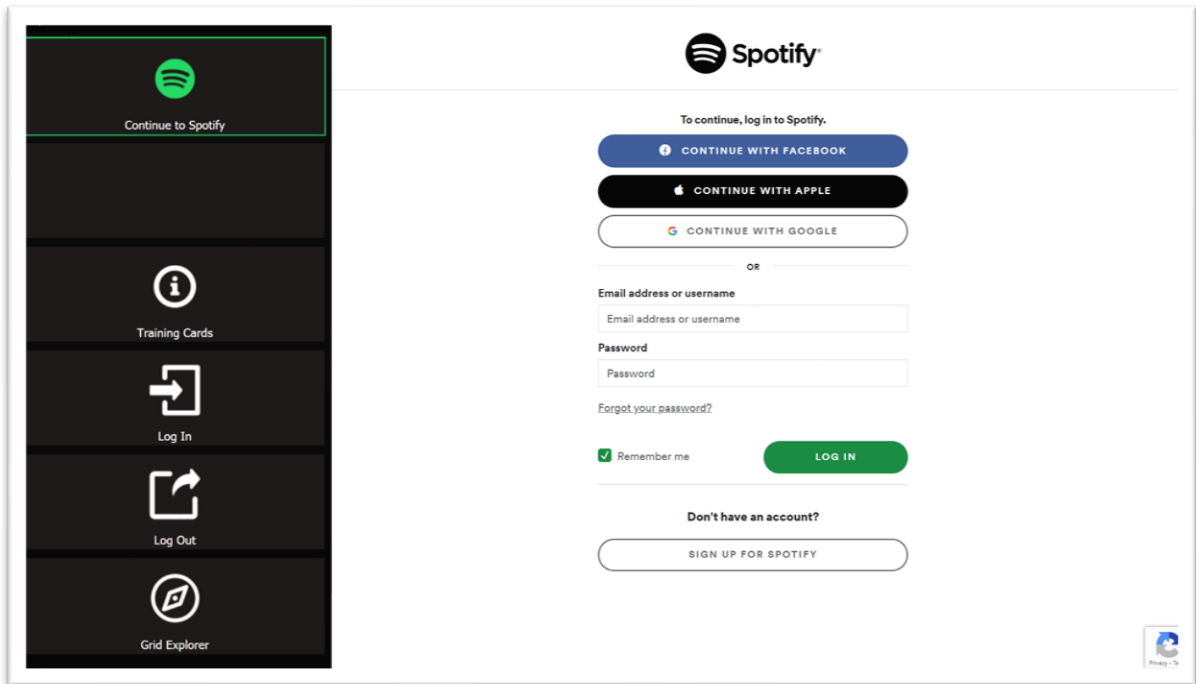

Getting Started

- Requirements – to use Join-In Spotify you need a Spotify account. Make sure you have your login and password available.
- **Login** – After selecting **Join-In Spotify** from your Grid 3 Grid Explorer, follow the sequence – **Login and Info** => **Log In** => **Username** => enter your Spotify account email => **Password** => enter your Spotify account password => **Log In**.
- You are now logged in to Spotify. Select **Continue to Spotify** to start using the app.
- Join-In Gridsets are available in different languages and optimized for use with different input devices. For most apps there is also a regular 'Full' version and a 'Lite' version with larger buttons and almost identical functionality. Please refer to the Join-In for Grid 3 [Getting Started](#) guide for information on how to download the Gridsets that are best for you.

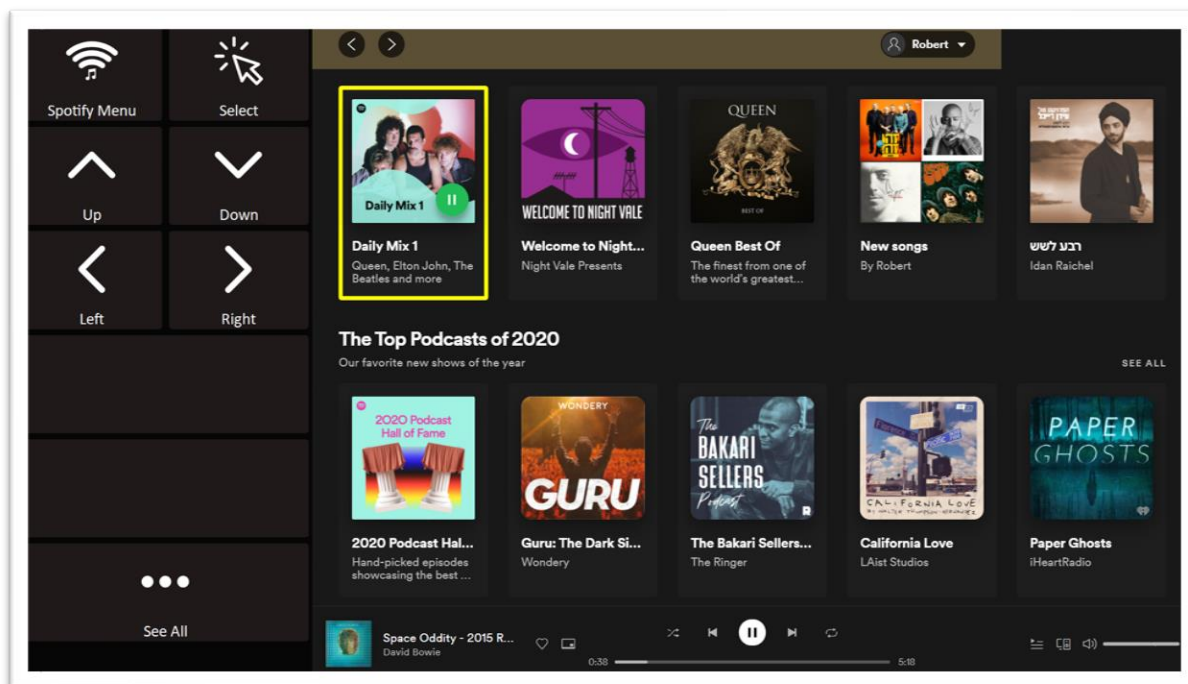

Home Page

- **Spotify Menu** – go to Spotify menu.
- **Up, Down, Left, Right** – navigate in the current screen. The currently selected item is shown with a yellow highlighted border.
- **Select** – Open the selected item page, with controls relating to the item type – playlist, artist, album etc.
- **See All** – open additional items in the current category you are in, when available.
- Return to Spotify Home Page from another page, by selecting **Home**.

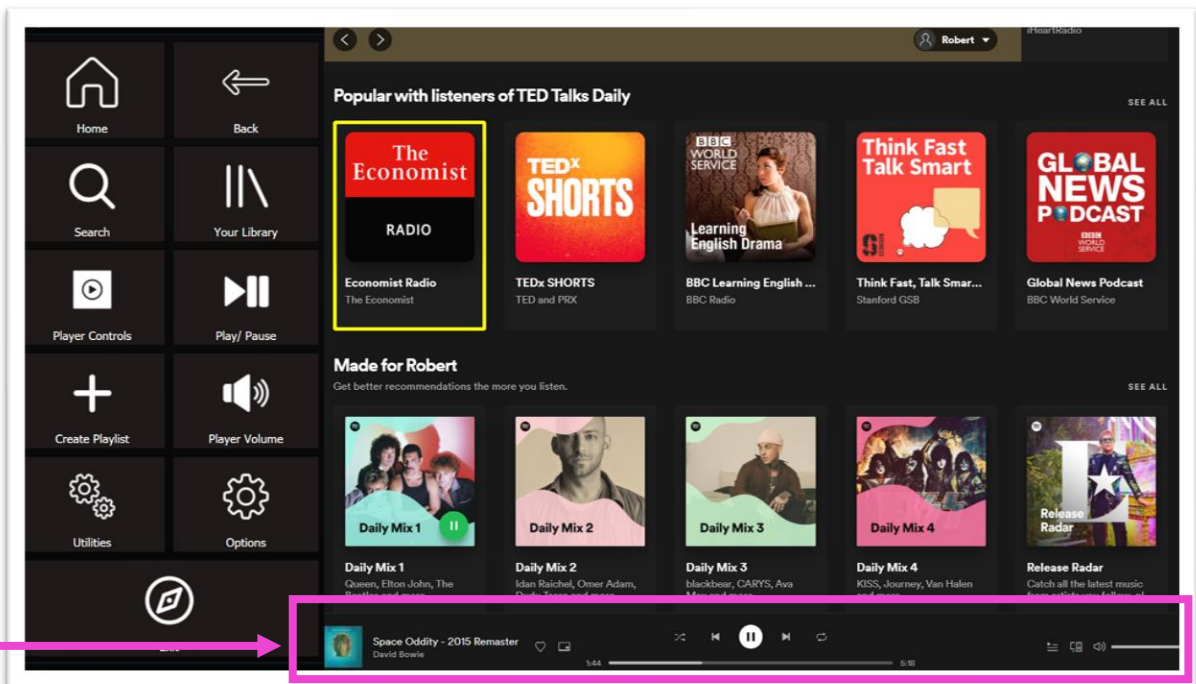

Menu

- **Home** – go to Spotify Home.
- **Search** – search for songs / albums / artists Etc.
- **Your Library** – go to your Spotify library – to browse your saved playlists, albums, artists and podcasts.
- **Create Playlist** – create a new playlist for adding songs to later.
- **Player Volume** – mute, volume up and volume down.
- **Player Controls** – for the song that is currently being player. This page allows you to control the toolbar shown at the bottom of the browser window. Play/pause, jump to the beginning or end of the song, jump 15 seconds forward or backward, toggle shuffle play, toggle repeat, connect to an external device.
- **Play/Pause** – play or pause the current song.
- **Utilities** – **Recover** / reopen Spotify, **Allow Touch** or **Block Touch** access, close windows you do not need, close popup messages, zoom in or zoom out...
- **Options** – change the computer volume, toggle text enlargement and set text size, auto-read settings, show or hide the left menu panel in the browser, login and logout of Spotify, and open the [Join-In Settings](#) app.
- **Exit** – exit Join-In Spotify to Grid 3 Grid Explorer. You can exit the Gridset without closing Spotify, so your music continues to play in the background.

Building a Playlist

Step 1: Create Playlist

Click **Create Playlist** on the **Spotify Menu** page. Add details using **Type Name** and **Type Description**, then **Save Playlist** to create an empty playlist for adding songs to.

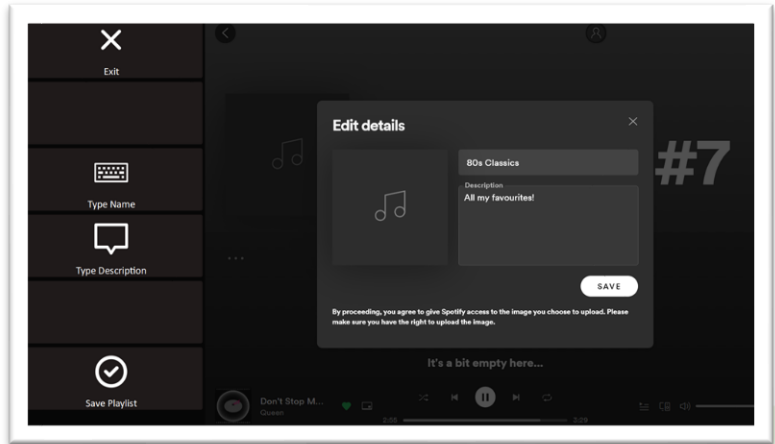

Step 2: Find Songs

When you find a song you like within another playlist or album, click **Add to Playlist**, the **Add to Existing Playlist** to bring up a list of your playlists, or **Create New Playlist** to make a fresh one at this point if you don't already have one set up.

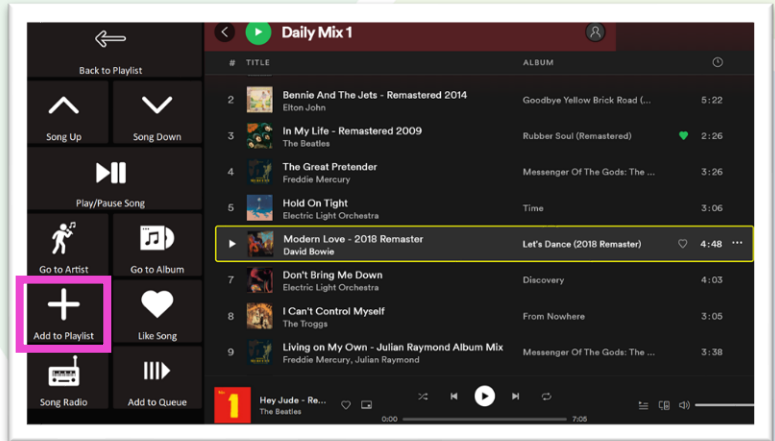

Step 3: Add Song to Playlist

If you selected **Add to Existing Playlist** you will be redirected to a menu toolbar to help you choose one. The buttons you see here depend on which control method your Gridset is optimized for; **Switch**, **Eye Gaze**, **Touch** or **Mouse Dwell**. Consult the [Join-In Settings](#) training cards for more information on how different versions of Join-In Gridsets work in situations like this.

If you are using the **Eye Gaze**, **Touch** or **Mouse Dwell** optimized versions of Join-In SMS, you will see a popup **Redirect Message** appear at the bottom of the page after selecting a playlist.

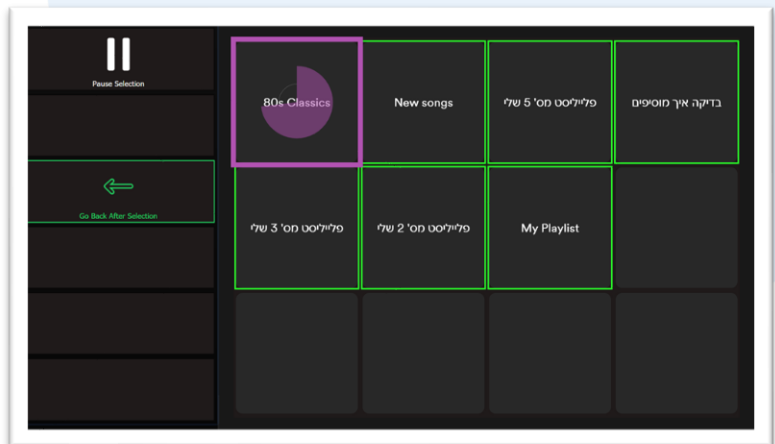

Redirect Messages

- In some parts of the Spotify website (e.g. **Home**, **Search Results**, etc.), clicking **Select** on an item will cause a **Redirect Message** to appear at the bottom of the screen.
- This message appears to help you redirect to Grid 3 toolbar to the right controls for the browser page you are about to visit.
- When you see this message, click the **Redirect Button** that matches the **Redirect Message** (e.g. **Go To Album**, **Go To Playlist**, **Go To Podcast**, etc.) .
- Redirect Buttons appear in different colors to the main theme. This is to emphasise that they are expected to work alongside a popup message. Always check for a message before clicking a button with different colors.

